

Features



- Dimensions: 41.9×37.1×10.7(mm)
- High efficiency :80% typical
- Low output noise and ripple
- Output Over-current Protection
- Baseplate operating temperature: -25℃ to +85℃

Numbering Convention

SFA - 48 S 5 - 15W F
 ① ② ③ ④ ⑤ ⑥

No.	Features	Descriptions
①	Product Series	SFA Small aluminum plate
②	Typical Input Voltage	C – Input Voltage: 48V
③	Number of Outputs	S – Single Output
④	Typical Output Voltage	5 – Output Voltage: 5V
⑤	Typical Output Power	15 – Output Power: 15W
⑥	Input Under-voltage Protection	Input Under-voltage Protection

1 Description

All the technical specifications, dimensions and pins of the SFA48S5-15WF series products are compatible with ERICSSON's PKS4111PI.

2 Technical Specifications

Parameter	Test Condition	Min	Typ	Unit
Input Voltage Range	36	48	72	(V)
Input Under-voltage Protection	28		34	(V)
Remote	off on	Zero Level +5 V or open circuit (reference to-Vin)		
Typical Output Voltage	4.95	5.00	5.05	(V)
Typical Output Current	—	3	—	(A)
Output Over-current Protection	3.6	—	4.5	(A)
Efficiency		≥80		(%)
Load Regulation (Vol)①	—		± 0.5	(%)
Line Regulation (Vov)	—		± 0.2	(%)
Output Ripple & Noise (mVp-p) ②	—	—	50	
Isolation voltage	1000	—	—	(Vdc)
Output Short-circuit Protection		Continuous, Recoverable		
Temperature Coefficient (Tcoeff)	—	±0.02	—	(%/°C)
Operating Case Temperature (Tc)	-25	—	+85	(°C)
Storage Temperature (Tst)	-55	—	+125	(°C)
MTBF		2×10 ⁵		(h)

Note:

- ① Load current: 0.1I_{nom} - I_{nom}.
- ② 20MHz Oscilloscope, probe testing

3 Thermal Derating Curve

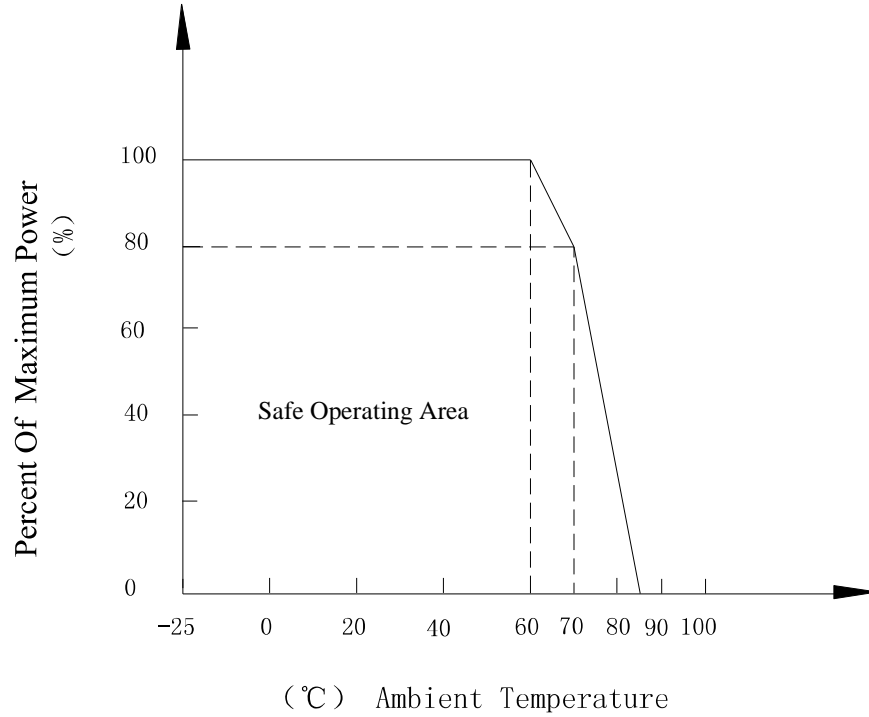

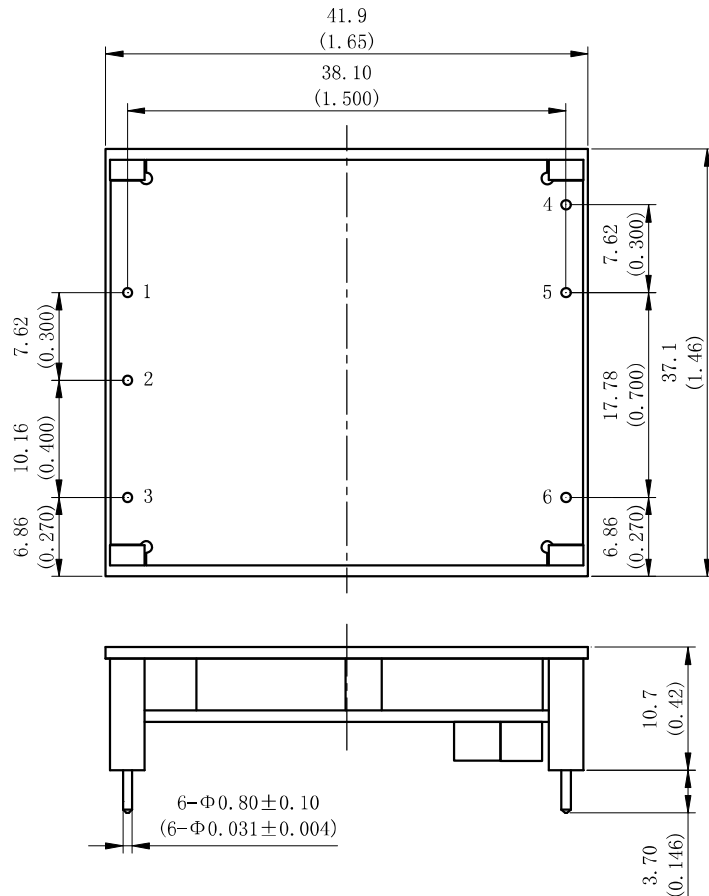
4 Dimensions and Pin definition

Unit: mm Tolerances: .x: ± 0.5 , .xx: ± 0.13

Pin Definition:

1: +Vin Positive input 2: -Vin Negative input 3: REM Remote

4: -Vout Negative output 5: +Vout Positive output 6: NC Connectionless